

## RRAERO Bracket kit Installation instructions

Replace one bracket at a time, new bracket is to replace existing bracket in the same position.

1. Remove old rear bracket and replace with new RRAERO rear bracket (bent to 90 degrees) in same position as the original rear bracket in the following order:

- Bolt (*Shown at the bottom on the Diagram*)
- Bracket
- Black washer x3
- Bar
- Nut

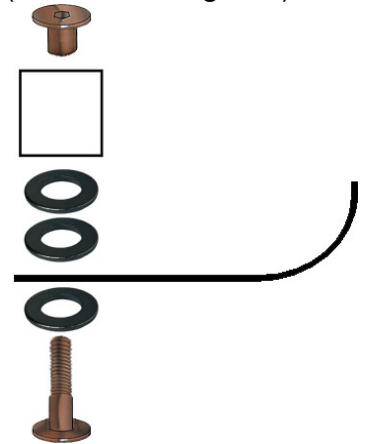

2. Tighten bracket so rear edge of bracket is flush with outside of bar

3. Remove old front bracket and replace new RRAERO front bracket (bent over centre) in same position as the original front bracket in the following order:

- Bolt (*Shown at the top on the Diagram*)
- Bracket
- Black washer x3
- Bar
- Nut

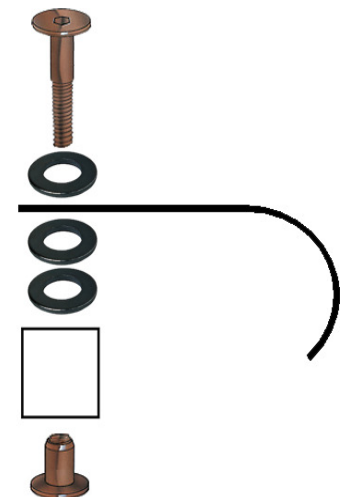

4. Tighten bracket so rear edge of bracket is flush with outside of bar

5. Remove old lock bar and replace new RRAERO lock bar in same position with the existing lock bar in the following order:

- Bolt (*Shown at the bottom on the Diagram*)
- Red washer
- Lock Bar
- Red washer
- Black Washer x1
- Bar
- Nut

Place 2 drops of loctite in the nut prior to installation

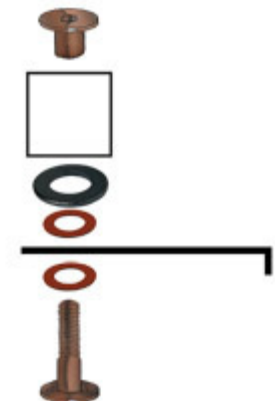

6. Tighten Lock bar so it is firm, but can still rotate. Leave 10 mins to dry

7. Test bar on roof racks for a snug fit. Move brackets in if too loose, move brackets out if too tight.